

# Adjustable Tablet Stand

ACC095

UPLIFT DESK

## Package Contents

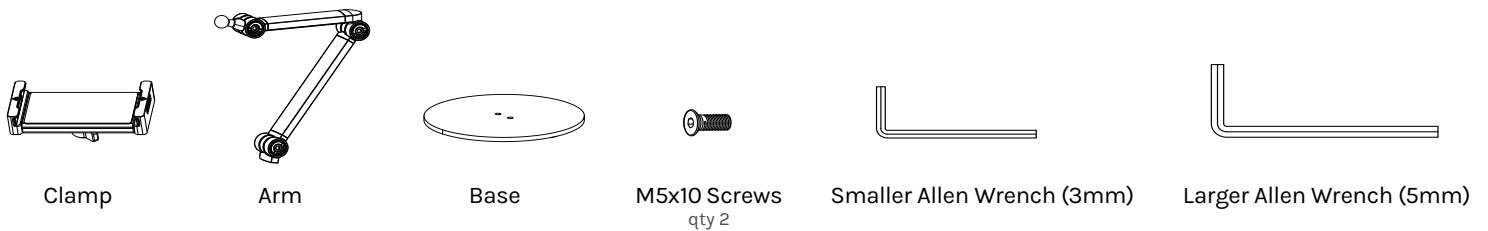

## Step 1 - Base Attachment

- Align the holes in the bottom of the Arm with the holes in the Base, with the countersunk holes for the screw heads on the opposite side of where the Arm will attach.
- Loosely insert the M5x10 Screws through the bottom of the Base and into the Arm.
- Once both screws have been started, tighten them with the Smaller Allen Wrench (3mm).

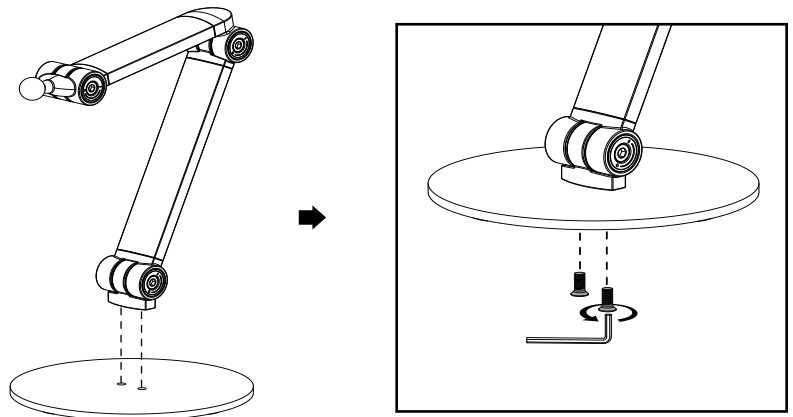

## Step 2 - Clamp Attachment - Ball and Socket Joint

- Remove the knob from the back of the Clamp by rotating it counterclockwise.
- Place the knob over the ball on the upper end of the Arm.
- Fit the threaded socket on the back of the Clamp over the ball.
- Rotate the knob clockwise to secure the Clamp to the Arm's ball.

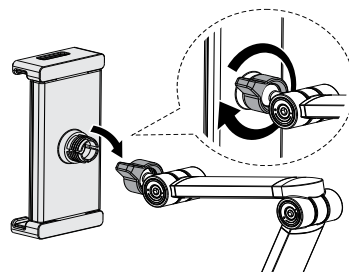
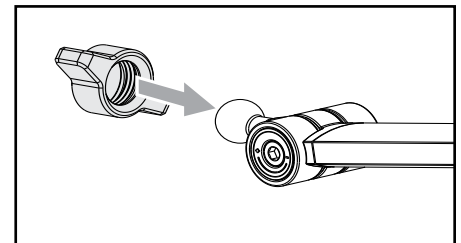
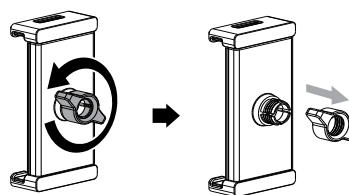

## Step 3 - Clamping Your Device

- The Clamp has a range of 5" to 8.9" and is spring-loaded to hold your device. Grasp each end of the Clamp and pull outward.
- Place your device between the ends of the Clamp and gently allow the ends to spring closed, gripping your device.

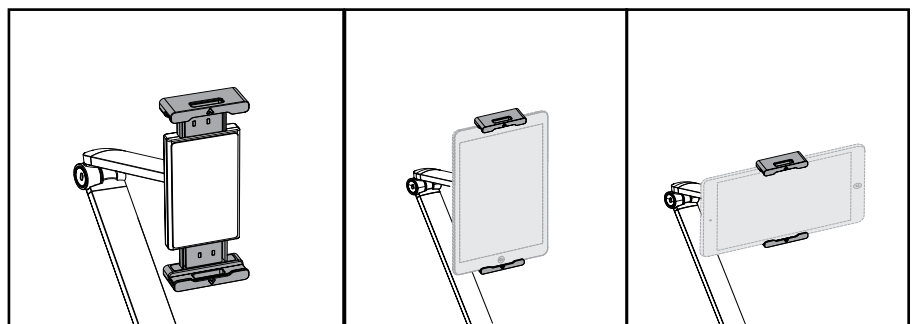

## Step 4 - Adjustments

- A. Slightly loosen the knob and adjust the rotation and angle of the Clamp.
- B. Tighten the knob to secure it in the new orientation.

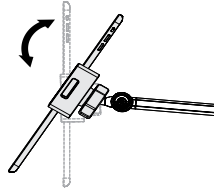
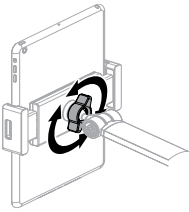

Tilt

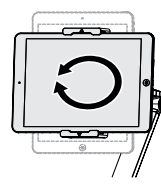

Rotate

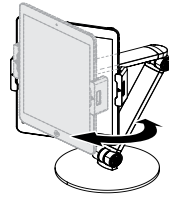

Swivel

- C. If the Arm droops and does not hold your device at your desired height, tighten the screws at the joints at the middle and bottom of the Arm using the Larger Allen Wrench (5mm).

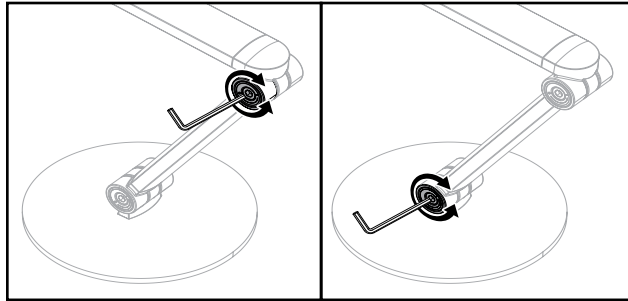

- D. If the Clamp droops and does not hold your device at your desired angle, tighten the screw at the end of the Arm where shown using the Larger Allen Wrench (5mm).

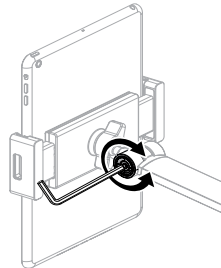

### ⚠ CAUTIONS & WARNINGS

- ⚠ **WARNING:** Please read this manual carefully. Under no circumstances does the manufacturer accept warranty or liability claims for damages caused from improper use or handling of this product. Provide this manual to any new user.
- ⚠ **CAUTION:** Read all instructions before assembly. Failure to assemble or operate properly may result in damage. Retain manual for future reference.

[upliftdesk.com](http://upliftdesk.com)  
[info@upliftdesk.com](mailto:info@upliftdesk.com)  
800-349-3839  
512-614-3152



Copyright Notice: This guide is a component of this UPLIFT Desk product. This guide is a part of the scope of delivery, even if the item is resold. This guide is also available on the UPLIFT Desk website: [upliftdesk.com](http://upliftdesk.com). These specifications are subject to United States copyright law.

### SAVE THE INSTRUCTIONS

Study this manual carefully. If this product is sold, please provide this manual to the buyer, installers, or support personnel operating the product.

AI-ACC095-1.0