

Corner Sleeve

SKU: UPL143

UPLIFT DESK®

Package Contents

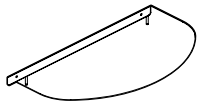

Corner sleeve top

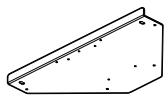

Corner sleeve bottom

#10-32x3/8" Machine screws
(qty 10)

#10x5/8" Wood screws
(qty 5)

Barrel nuts
(qty 2)

These parts are provided with your Keyboard Tray:

21" Keyboard tray track

#10x5/8" Wood screws
(qty 8)

Track guard

Back bumper

Note: This product was designed to have a Keyboard Tray attached to it, but it can also be used in the corner of your desk without a Keyboard Tray. See page 2 for Assembly without Keyboard Tray.

Assembly with Keyboard Tray

Step 1

Use four #10-32x3/8" Machine screws to attach the 21" track from your Keyboard tray to the bottom half of the Corner sleeve.

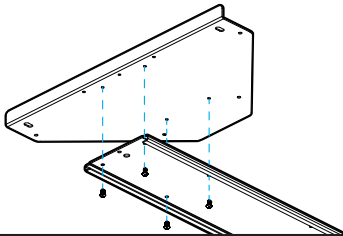

Step 2

Take the Corner sleeve top and position it over the Corner sleeve bottom as shown.

Install the Barrel nuts through the holes in the Corner sleeve bottom as shown and loosely attach them to the threaded posts in the Corner sleeve top. Do not tighten the Barrel nuts until Step 4.

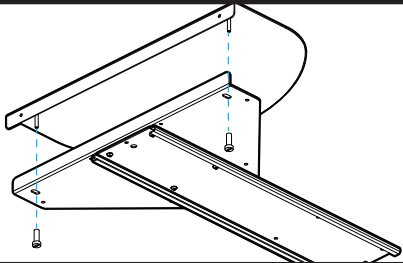

Step 3

If your L-shape desk has a small support bracket attached under the inside corner at the seam where the Main and Return desktop meet, remove it before proceeding to Step 4.

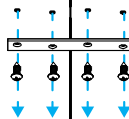

Step 4

Slide the Corner sleeve at a 45° onto the inside corner of the desktop. Once it is in place, tighten the Barrel nuts to secure it.

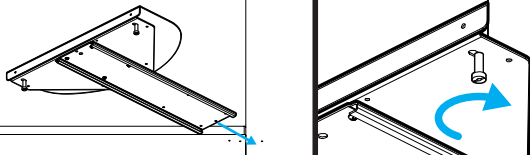

Step 5

Using eight #10x5/8" Wood screws where shown, attach the Corner sleeve bottom and the Keyboard tray track to the desktop.

If you own a drill, you can make pilot holes to make it easier to install the screws. Using a 1/8" diameter drill bit, drill pilot holes in the eight locations shown ensuring that you DO NOT DRILL DEEPER THAN 1/2".

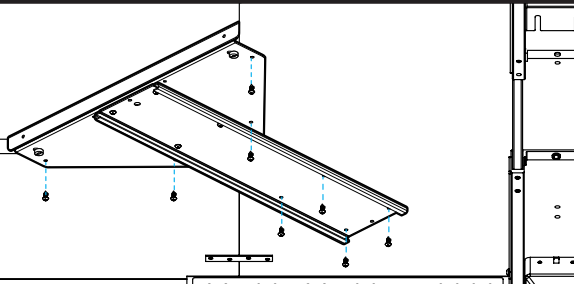

Step 6

Attach the Back bumper through the middle hole at the back of the track as shown using a screw from the Keyboard tray kit as shown.

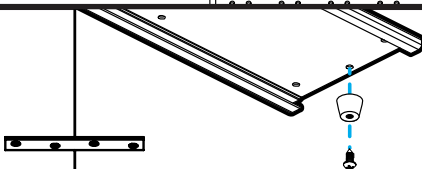

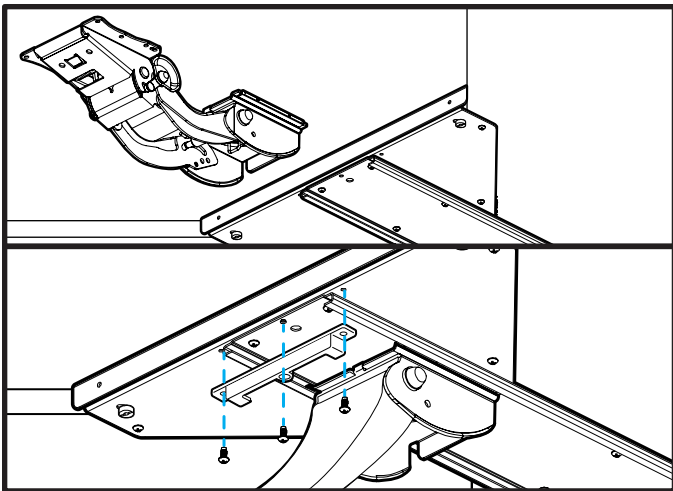

Step 7

Find the Keyboard tray mechanism from the Keyboard tray kit. Line up the mechanism with the grooves on the track and slide it in.

Please note: the mechanism will not adjust up or down until the tray has been attached and the shipping pin is removed. Refer to the instructions that come with your Keyboard tray for the rest of the Tray assembly.

Step 8

Attach the front Track guard using three #10-32x3/8" Machine screws as shown.

Assembly without Keyboard Tray

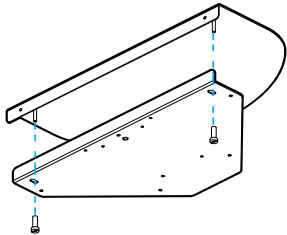

Step 1

Take the Corner sleeve top and position it over the Corner sleeve bottom as shown.

Install the Barrel nuts through the holes in the Corner sleeve bottom as shown and loosely attach them to the threaded posts in the Corner sleeve top. Do not tighten the Barrel nuts until Step 3.

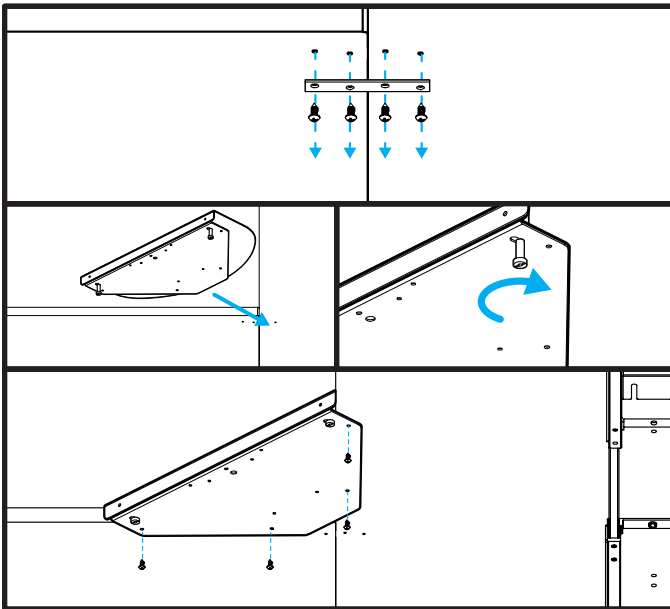

Step 2

If your L-shape desk has a small support bracket attached under the inside corner at the seam where the Main and Return desktop meet, remove it before proceeding to Step 3.

Step 3

Slide the Corner sleeve at a 45° onto the inside corner of the desktop. Once it is in place, tighten the Barrel nuts to secure it.

Step 4

Use four #10x5/8" Wood screws where shown, to attach the Corner sleeve bottom to the desktop.

If you own a drill, you can make pilot holes to make it easier to install the screws. Using a 1/8" diameter drill bit, drill pilot holes in the eight locations shown ensuring that you DO NOT DRILL DEEPER THAN 1/2".

⚠ CAUTIONS & WARNINGS

⚠ CAUTION: Read all instructions before assembly. Failure to assemble or operate properly may result in damage.

© Copyright Notice: These instructions are a component of this UPLIFT Desk Accessory. These instructions are part of the scope of delivery, even if the item is resold. These instructions are also available on the UPLIFT Desk website: upliftdesk.com. Excerpts or copies may not be forwarded to third parties or used in any other published form without the prior written consent of UPLIFT Desk. These instructions are subject to United States copyright law.