

# Power Grommet with USB

PDC019

UPLIFT DESK

Work better. Live healthier.

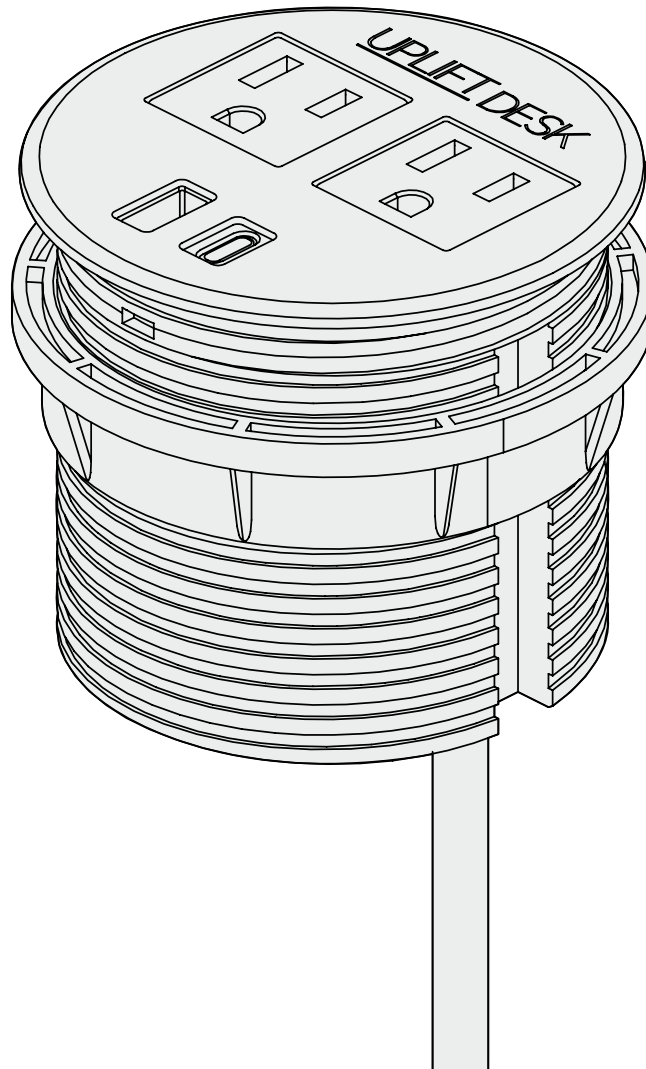

Scan QR code for  
product webpage



## Safety and Warnings



**WARNING:** Read all instructions before assembly. Failure to assemble or operate properly may result in damage or personal injury. Retain manual for future reference.



**WARNING:** To avoid overheating and possible damage to this product and other equipment, do not use it to power devices that exceed the designed ratings.



**WARNING:** This product must be installed and/or used in accordance with the appropriate electrical codes and regulations.



**WARNING:** For indoor use only. Use only in dry areas.



**WARNING:** Avoid getting liquid on or in the unit, as it can cause shock and fire. If the unit gets wet, disconnect the power at the circuit breaker or outlet. Ensure the unit is completely dry before reconnecting to the power source.



**WARNING:** Do not attempt to open the unit to perform service. Dangerous voltages are present inside the unit.



**WARNING:** The Power Grommet with USB needs a path to ground to work properly and should only be plugged directly into a grounded 120V outlet. Do not plug the Power Grommet into another power strip or surge protector, it could exceed the electrical capacity of the power strip or surge protector and lead to personal injury. For example: If a four outlet power strip has 3 devices plugged in and you plug this Power Grommet into the fourth outlet, the power strip becomes 5 outlets and could overload the rated power.

Plugging the Power Grommet into a voltage converter is considered improper use and can damage the unit, causing a hazardous situation possibly leading to personal injury.

Under no circumstances does the manufacturer accept warranty or liability claims for damages caused from improper use of this product. Provide this manual to any new user.

## Package Contents

Power Grommet



Locking Ring

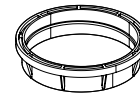

## Assembly Instructions

Installation of the Power Grommet with USB requires a hole through the desktop measuring 3.15" (80mm) in diameter and a desktop thickness up to 2".

The Power Grommet with USB should not be plugged into other power strips. It should only be plugged into a grounded wall or floor outlet. Use the Power Grommet for providing power to items located on top of the desk. Use a secondary power strip such as the 4-Outlet Mountable Surge Protector or 8-Outlet Mountable Surge Protector for powering items located below the desk.

### Step 1 - Remove Locking Ring

- Unscrew the Locking Ring from the body of the Power Grommet.
- Slide the Locking Ring completely off of the power cord and set it aside for Step 3.

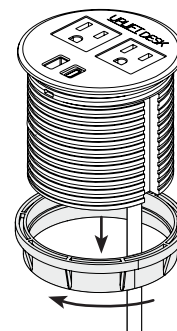

## Step 2 - Insert Power Grommet in Grommet Hole

- From the top side of the desktop, feed the Power Grommet's power cord through the grommet hole.
- Place the Power Grommet into the grommet hole and lower it until it is flush with the surface of the desktop.

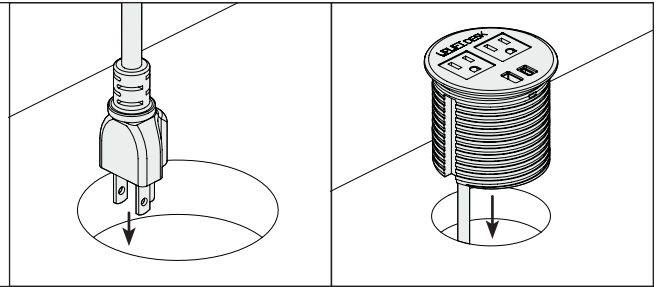

## Step 3 - Replace the Locking Ring

- Slide the Locking Ring over the end of the power cord under the desk in the orientation shown until it reaches the bottom of the Power Grommet.
- Begin to screw the Locking Ring onto the threaded portion of the Power Grommet.

The Locking Ring should rotate smoothly when properly engaged with threads. If it does not rotate easily, it could be cross-threaded; unscrew it and try again. Do not force thread it.

- Continue screwing the Locking Ring until it is tight against the underside of the desktop.

If you need to adjust the orientation of the Power Grommet in the grommet hole, slightly loosen the Locking Ring, rotate the body as needed, and tighten the Locking Ring again.

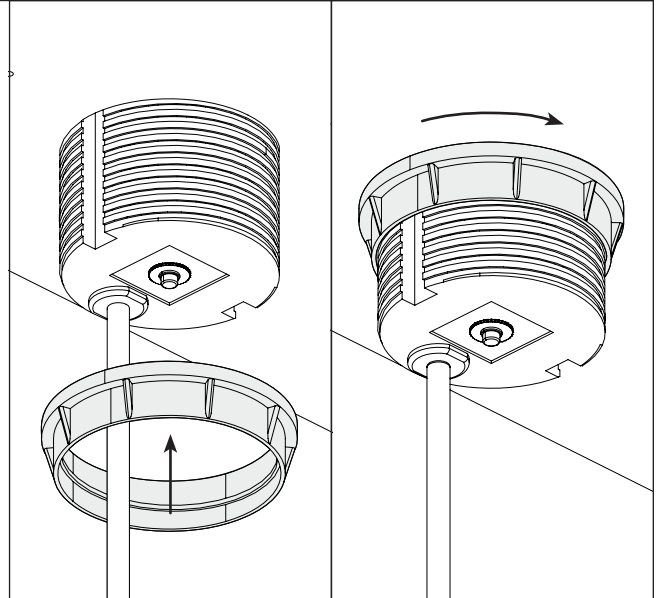

## Step 4 - Using the Power Grommet with USB

- The Power Grommet's power cord is 10' long. Be sure the outlet you plan to plug it into is close enough to avoid pulling on the cord if installed on a height adjustable desk. For the cleanest appearance, we recommend routing the cord through one or more of the cable mounts provided with your UPLIFT Desk frame and to the nearest desk leg. We also recommend using a Magnetic Cable Channel attached to the leg as shown. Plug the power cord into a grounded, 120V wall or floor outlet.
- The Power Grommet has overload protection. If the unit stops functioning, press the reset button located on the bottom of the unit. If it does not function after pressing the reset button, the unit has been damaged by a power surge and should be replaced.

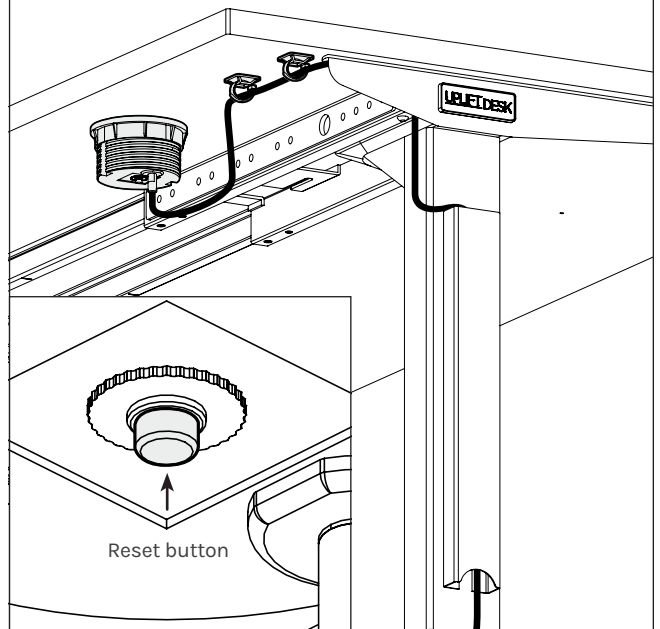

## USB port specifications:

- USB output when only one USB port is used:
  - USB-A output: 5VDC/3A, 9VDC/2A, or 12VDC/1.5A (max 18W) with Quick Charge 3.0 and Power Delivery 3.0
  - USB-C output: 5VDC/3A, 9VDC/2A, or 12VDC/1.5A (max 18W) with Power Delivery 3.0
- USB output when both ports are used at the same time: Intelligent power distribution allows 5V/3A (15W) to be shared between the two ports
- USB ports are for charging only and cannot be used for transferring data

## Power ratings:

- 12A, 120V max
- Overload protection with reset button on bottom
- ETL safety listed in the US and Canada

# UPLIFT DESK

Work better. Live healthier.

[upliftdesk.com](https://upliftdesk.com)

[info@upliftdesk.com](mailto:info@upliftdesk.com)

800-349-3839

512-614-3152

## SAVE THIS MANUAL

Study this manual carefully. If this product is sold, please provide this manual to the buyer, installers, or support personnel operating the product.



Copyright Notice: This manual is a component of this UPLIFT Desk product. This manual is a part of the scope of delivery, even if the item is resold. This manual is also available on the UPLIFT Desk website: [upliftdesk.com](https://upliftdesk.com). This manual is subject to United States copyright law.