

Flex Chair Dolly

ACC074

UPLIFT DESK

Package Contents

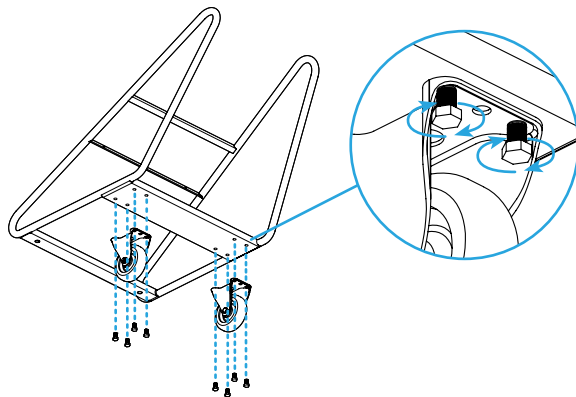
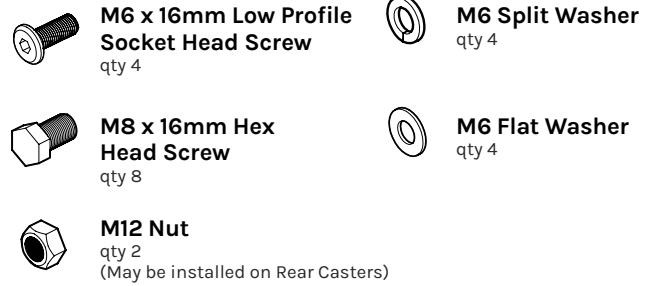
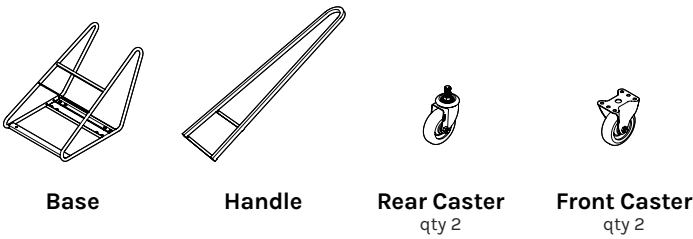

Step 1 - Front Caster Attachment

- Align the holes in the mounting plates of the Front Casters with the holes in the Base as shown.
- Insert an M8 x 16mm Hex Head Screw into each of the holes.
- Once all eight screws have been started, tighten them completely using a 13mm (1/2") flat wrench, socket, or adjustable wrench.

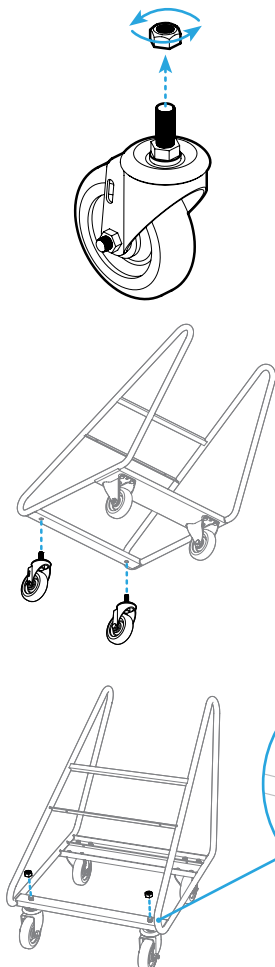

Step 2 - Rear Caster Attachment

- Remove the M12 Nuts from the threaded stems of the Rear Casters if they are not provided in a separate hardware bag.
- Insert the threaded stem of the Rear Casters through the holes at the front of the Base as shown.
- Thread the M12 Nuts onto the threaded stems of the Rear Casters and tighten them using two 19mm (3/4") flat wrenches or adjustable wrenches

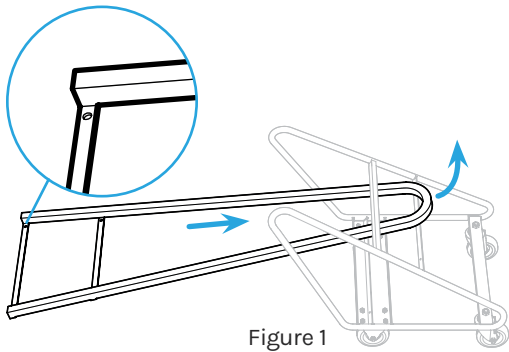
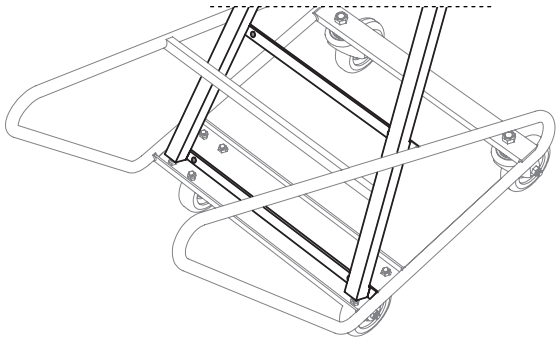

Figure 1

Step 3 - Handle Attachment

- A. Slide the Handle between the two crossbars of the Base as shown, with the Handle crossbars oriented toward the ground (see Figure 1).



- B. Rest the wide end of the Handle against the ridge in the Base as shown so the four holes in the Handle align with the four holes in the Base frame.

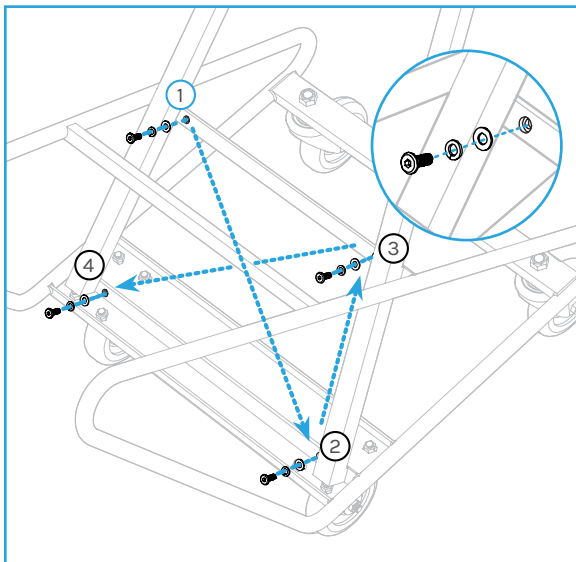

- C. Loosely insert an M6 x 16mm Hexagon Low Profile Socket Head Screw with an M6 Split Washer and an M6 Flat Washer into each of the four holes in a diagonal pattern as shown to help keep the Handle in place.
- D. Once all Screws have been started, tighten them completely with a 4mm Allen Wrench.

Step 4 - Stacking the Flex Chairs

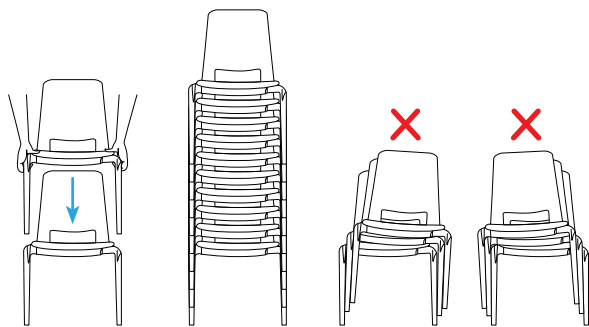

- A. The Flex Chair Dolly can accommodate up to ten stacked Flex Chairs.
- B. Stack chairs from the front, ensuring the legs of the chair being stacked are evenly centered over the legs of the chair below it to keep the stack straight.
- Caution:** If the chair stack is crooked, restack the chairs so it's straight. Attempting to move crooked stacks can result in injury. Do not try to move stacks that are not straight.

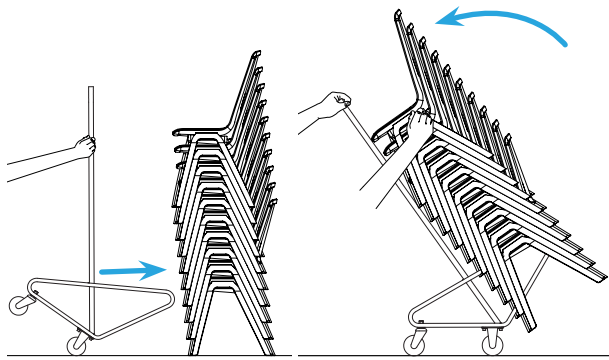

Step 5 - Loading Chair Stacks onto the Dolly

- Stacks of Flex Chairs can be moved from either the front or the back of the stack.
- Tilt the Flex Chair Dolly forward onto the two Front Casters with the Handle nearly vertical.
- Roll the forks of the Dolly Base between the chair legs until the Handle makes contact with the chairs.
- Holding the top of the Handle with one hand and the stack of chairs with the other, carefully tilt the Handle and chair stack back toward you until the Dolly is resting on all four casters.

Caution: If you are loading the Dolly from the back side of the chair stack, be careful to avoid pinching your hand between the backs of the chairs and the Handle.

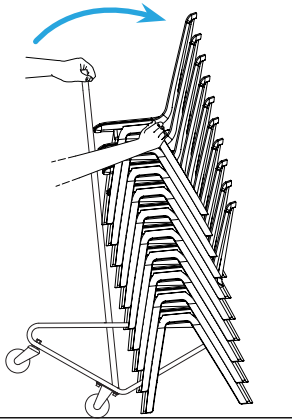

Step 6 - Moving and Unloading the Dolly

- Roll the Dolly with chair stack to the desired location, guiding it with one hand on the Handle and the other hand holding the stack of chairs steady.

Attention: Be very careful when rolling over door thresholds, floor transition strips, bumps, or the edge of runners. Hold onto the stack of chairs carefully before slowly rolling the Dolly's wheels over the bump.

- When you are ready to set the stack of chairs down, carefully tilt the Handle forward holding the chairs steady until all four legs of the first chair in the stack are on the ground. Pull the Dolly out and move on to the next stack or leave it in place for storage until you need to move the chairs again.

Safety and Warnings



CAUTION: Read all instructions before assembly. Failure to assemble or operate properly may result in damage or personal injury. Retain manual for future reference.



WARNING: This product's maximum capacity is ten Flex Chairs. DO NOT exceed the maximum capacity.



WARNING: Do not stand, sit, or ride on the Flex Chair Dolly.



WARNING: Do not allow children to use the Flex Chair Dolly.

Under no circumstances does the manufacturer accept warranty or liability claims for damages caused from improper use of this Flex Chair Dolly. Please provide these instructions to any new user or owner of the Flex Chair Dolly.

UPLIFT DESK®

Work Better. Live Healthier

upliftdesk.com

info@upliftdesk.com

800-349-3839

512-614-3152

SAVE THE INSTRUCTIONS

Study this manual carefully. If this product is sold, please provide this manual to the buyer, installers, or support personnel operating the product.



Copyright Notice: This guide is a component of this UPLIFT Desk product. This guide is a part of the scope of delivery, even if the item is resold. This guide is also available on the UPLIFT Desk website: upliftdesk.com. These specifications are subject to United States copyright law.